

GXA-27 Bluetooth® Interface for GX-A/GF-A series

GXA-27 is a Bluetooth communication option. By pairing specific product, PC, tablet or smartphone equipped with Bluetooth function, you can communicate with the balance. Dust and waterproof balances can communicate with Bluetooth device by using GXA-27 maintaining its performance.

1. Installation Procedure

Note: Before installing the GXA-27 option board, disconnect the AC adapter from the balance.

- Step1 Remove the two screw from the panel.
pull gently the cable and option board from the balance.
- Step2 Peel off the connector that is affixed to the panel with double-sided tape and insert it into the socket of the option board.
- Step3 Attach the option board to the balance.
Fix the option panel with two screws removed in step1.

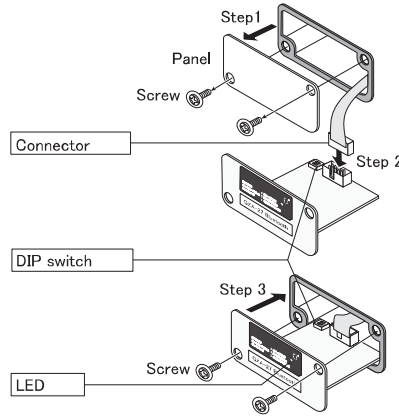

2. Support models

GXA-27 supports following models:

GX-A / GF-A / GX-AWP / HR-AZ / HR-A / FZ-i / FX-i / FZ-iWP / FX-iWP

3. Connectable device

- AD8931 :Wireless Remote Display
- AD8541-PC :Wireless Communication Interface for PC
(Connect to USB port of computer)
- Smartphone / Tablet / PC with Bluetooth

4. DIP switch settings

GXA-27 has two dip switches. DIP switch No.1 sets connection method with Bluetooth device and dip switch No.2 set giving or not giving a serial number (S/N) to the weighing value. Refer to the following table, adjusting the settings of the switch 1 and 2 depending on your application.

Connection status		DIP switch		Output Data
		No.1	No.2	
1	Keyboard input No S/N (Factory Setting)	HID	S/N	Only numerical data (No header, +sing and unit) Example 1) 1.23 Example 2) -4.56 ↑ Data
		ON	OFF	
2	Keyboard input With S/N	HID	S/N	Add S/N after numerical data (Same as case 1 if the balance has no S/N setting) Example 1) 12345678 1.23 Example 2) 901234567 -4.56 ↑ ↑ ↑ S/N Tab Data
		ON	ON	
3	Two-way communication*1	HID	S/N	Connect to AD8931 or AD8541-PC
		OFF	OFF	

*1 See the AD8931 or AD8541-PC manual how to set the communication functions.

5. Keyboard input (HID Over GATT Profile)

- By turning on DIP switch No.1, you can enter the weighing value as a keyboard input in a general purpose text application on your PC, smartphone and tablet.
- The output data has no header (ST, WT, etc.), + sing and unit (g, kg, etc.).
- Set the input mode of device to English.
- By turning on DIP switch No.2, you can give a serial number (S/N) of the balance to the weighing value.

6. Pairing

- Turn on the Bluetooth function of device and power on the balance. Select the "A&D_HID" device and pair.
S/N may be added after "A&D_HID".
- You can only pair 30 seconds after selecting the Bluetooth device. If 30 seconds have passed without pairing, turn off the balance and try pairing again.

7. Precautions for use

- Refer to the instruction manual of the connection device for the pairing.
- The LED lights up when the wireless communication connection is completed.
- It will connect automatically when the paired device is nearby. When connecting to other device, turn off the unused devices or unpairing GXA-27 and Bluetooth device.
- If you can't communicate with the balance, check the connection of the balance and the GXA-27, settings of the balance, pairing and connected device status.

8. Wireless communication

- Bluetooth devices is EYSHCNZXX (TAIYO YUDEN CO.,LTD.)/Bluetooth 5.0 (Bluetooth Low Energy)
- The effective range communication is 10 m or less in an unobstructed space.
If there is an obstacle such as a wall, the range of communication will be shorter.
- Interference may be caused near the following devices that use the 2.4 GHz frequency band, which is the same as for Bluetooth. Therefore, this device is not suited for uses that require reliability.
 - Wireless LAN
 - Bluetooth devices (such as mobile phones)
 - Home appliances such as microwave ovens

9. Compliance

9-1. Compliance with FCC Rules

This device contains transmitter module FCC ID : RYEEYSHCN

This device complies with Part 15 of the FCC rules. Operation is subject to the following two conditions :

- (1) this device may not cause harmful interference, and (2) this device must accept any interference received, including interference that may cause undesired operation. (FCC = Federal Communications Commission in the U.S.A.)

FCC warning

Changes or modification not expressly approved by the party responsible for compliance could void the user's authority to operate the equipment.

Note : This equipment has been tested and found to comply with the limits for a class A digital device, pursuant to part 15 of the FCC rules. These limits are designed to provide reasonable protection against harmful interference when the equipment is operated in a commercial environment. This equipment generates, uses, and can radiate radio frequency energy and, if not installed and used in accordance with the instruction manual, may cause harmful interference to radio communications. Operation of this equipment in a residential area is likely to cause harmful interference in which case the user will be required to correct the interference at his / her own expense.

9-2. IC

IC RADIATION EXPOSURE STATEMENT FOR CANADA

This device complies with Industry Canada license-exempt RSS standards. Operation is subject to the following two conditions : (1) this device may not cause interference, and (2) this device must accept any interference, including interference that may cause undesired operation of the device.

This device contains transmitter module IC : 4389B-EYSHCN